



WESTERN REGIONAL CONFERENCE ON GAMBLING AND GAMING HEALTH AWARENESS

# FOCUS ON THE FUTURE

April 29- May 2, 2024

CONFERENCE COORDINATOR



CONFERENCE PARTNERS



## PORTLAND, OR

Holiday Inn Portland – Columbia Riverfront



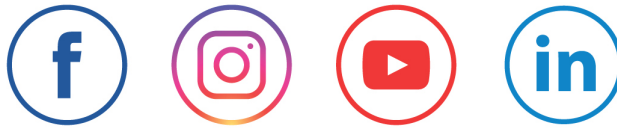

## Insightful, Engaged, and Inspired Networks

Scan this code to see a list of our social accounts. We hope you can join us in raising awareness for Problem Gambling and Gaming.



Share photos & comments during the conference! Tag them **#FoF24**

# WELCOME TO ***FOCUS ON THE FUTURE!***

When ***Focus on the Future*** launched in 2007, we hoped it would provide opportunities for everyone working in the field of addictions treatment and prevention to learn more about problem gambling, network with colleagues, and share successes and challenges. It was a start. Today, we understand better the importance of and need for services along a full Continuum of Care. When we offer services from Prevention and Treatment to Intensive Treatment and Recovery Support Services – working together as community organizations, behavioral health, and governmental agencies – we can help people make healthier choices.

This week, you'll have opportunities to attend sessions with leaders in the field on a broad spectrum of topics from ***Using Inclusive Language to Build Trust*** to ***Reviewing Emerging Treatments***; from ***Trauma and PTSD Among Individuals with Gambling Disorder*** to ***Voices of Recovery***; and from ***How to Comply with HIPAA Rules for Behavioral Health Providers*** to ***Motivational Interviewing: Refining Reflective Listening Skills***; and more. Still with the rapidly evolving landscape of Gambling and Gaming, there is much yet to talk about and much to do – together.

You have made it possible to work as partners and colleagues – as a special community --- to help many communities. Thank you all for the great work you do to make a difference in the lives of so many and for sharing your passion and knowledge at ***Focus on the Future*** 2024.

Warmly,

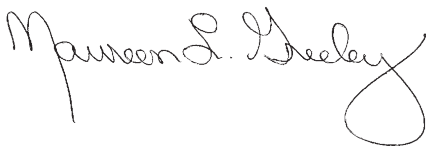

Maureen Greeley  
Executive Director





# ABOUT THE EVERGREEN COUNCIL ON PROBLEM GAMBLING



## Evergreen Council on Problem Gambling

The Evergreen Council on Problem Gambling (ECPG) is a 501(c)(3) nonprofit organization dedicated to increasing awareness of public health issues around problem gambling and gaming in diverse cultures, expanding the availability and integration of services, and supporting advocacy, research, and programs for education, prevention, treatment, recovery, and responsible gambling and gaming. ECPG is committed to providing services and programs for individuals, families, employers, students, treatment professionals, gaming industry employees, and the greater community. We accomplish this through the daily execution of our Mission, Vision, and Core Values. Founded in 1991, ECPG maintains a position of neutrality on gambling, recognizing that gambling is a personal choice and most people who gamble do so for recreation and suffer no serious problems.

WASHINGTON STATE'S CONFIDENTIAL 24-HOUR

**PROBLEM GAMBLING HELPLINE**

**CALL. TEXT. CHAT. 1-800-547-6133**

VISIT [EVERGREENCPG.ORG](http://EVERGREENCPG.ORG) TO CHAT





# CONFERENCE PARTNERS



## Oregon Health Authority

Helping people and communities achieve optimum physical, mental, and social well-being through partnerships, prevention, and access to quality, affordable health care is the mission of the Oregon Health Authority. Problem Gambling Services is part of OHA's Health System Division. Oregon invests more than five million dollars annually to reduce and/or prevent the negative effects of gambling.



OREGON COUNCIL on PROBLEM GAMBLING

## Oregon Council on Problem Gambling

The Oregon Council on Problem Gambling was established in 1996 and has been an affiliate of the National Council on Problem Gambling since 1998. The Council's purpose is to promote the health of Oregonians by supporting efforts to minimize gambling related harm through research, education, and advocacy.



## Washington State Health Care Authority – Division of Behavioral Health & Recovery Problem Gambling Program

HCA's Problem Gambling Program provides treatment services free of charge to individuals and families in agencies throughout the state. Nearly 70% of the funding DBHR receives for problem gambling goes toward treatment services. They also fund training and prevention initiatives in collaboration with ECPG, and fund scholarships to treatment providers, students, and school counselors to attend ECPG conferences and quarterly training workshops.





# THANK YOU

## TO OUR PARTNERS AND SPONSORS

### CONFERENCE PARTNERS



### SCHOLARSHIP & TRAINING PARTNERS



### GOLDEN EAGLE GUARDIAN



### SILVER SALMON SPONSORS



### COPPER RIVER CONTRIBUTOR





EVERGREEN  
council on problem gambling

We hope that all players can enjoy our games, but we know that for some, gambling can become an issue. For those players, and for everyone, we want to provide tips, resources, and tools for staying safe and getting help when it's needed.



Call or Text  
1-800-547-6133



## More awards than rainy days in January.

Most awards in Puget Sound

Learn more at:

[ProvidenceSwedish.org/usnews](https://ProvidenceSwedish.org/usnews)



Providence  
**SWEDISH**

# #YHTP2



EVERGREEN  
council on problem gambling

[evergreencpg.org/awareness/gambling-gaming-and-youth/](https://evergreencpg.org/awareness/gambling-gaming-and-youth/)

# Sq<sup>w</sup>ali 'abš

people of the river - people of the grass



"Whatever the future holds, do not forget who you are!  
Teach your children, your children's children, and then teach their children also. Teach them the pride of a great people...  
A time will come again when they will celebrate together with joy.  
When that happens my spirit will be there with you."

Leschi, Last Chief of the Nisquallys  
1808 - 1858





WESTERN REGIONAL CONFERENCE ON PROBLEM GAMBLING AWARENESS  
**FOCUS ON THE FUTURE**

PRE-CONFERENCE SCHEDULE

Monday, April 29

7 - 8 a.m.

Registration

Main Lobby

Breakfast

Clark

8 a.m. - Noon

Concurrent Workshops

***Analysis and Basics of Integrating Gambling & Gaming Recovery Skills into Practice (Part 1)***

**Multnomah**

Presented by: Kitty Martz, CGRM, CGAC-II, MBA and Tana Russell, SUDP, NCTTP, WSCGC-II, CGT

This highly interactive workshop is designed as a “Gambling and Gaming 101” for clinicians, peers, and administrators to become familiar with the basics of gambling, gaming, and their overlap; understanding them as addictive disorders and how they differ from SUD/MH; screening and referral techniques; and an overview of treatment, barriers, and future trends. Tana Russell, a Certified Gambling Counselor, and Kitty Martz, a Certified Gambling Recovery Mentor, are both advocates for integrating problem gambling and gaming services into MH/SUD programs. They’ll provide a critical SWOT analysis of the strengths, weaknesses, opportunities, and threats to integrating this work for both treatment professionals and peers. Get ready to write and stretch because this session will be interactive, engaging, and possibly challenging.

8 - 10 a.m.

Concurrent Workshops

***Disrupting the Trajectory – Early Child Screen Management Initiatives Could Alter the Course of Youth Screen Addiction***

**Clackamas**

Presented by: Cris Rowan

This trajectory from early and excessive screen overuse by children, to youth screen addiction, is observable, measurable, and thus predictable, offering clinicians rich information required to design multiple paths of intervention. The new Screen buster peer certification training program for teens is profiled and the Survivor Unplugged Challenge is presented. Listening and learning from youth in media addiction centers about how to better manage balance between screens and healthy activity, is a key element in understanding current escalating screen overuse leading to potential addiction in young children.





10 a.m. – Noon

Concurrent Workshops

***Prevention Essentials: Prevention in Practice The SPF and more***

**Timberline**

Presented by: Karen Hlady, MA, GIS, IGDC

This session introduces the audience to prevention goals, the spectrum of behavioral health, the Strategic Prevention Framework, CADCA's best practices and strategies for implementing evidence-based prevention programs. Time permitting, we will each draft a prevention plan pertinent to our respective communities. The intention of this session is to inform policy and practice when designing and funding prevention programs.

Noon – 1 p.m. Lunch/Break Exhibits

Clark

1 – 5 p.m.

Concurrent Workshops

***Analysis and Basics of Integrating Gambling & Gaming Recovery Skills into Practice (Part 2)***

**Multnomah**

Presented by: Kitty Martz, CGRM, CGAC-II, MBA and Tana Russell, SUDP, NCTTP, WSCGC-II, CGT

This highly interactive workshop is designed as a "Gambling and Gaming 101" for clinicians, peers, and administrators to become familiar with the basics of gambling, gaming, and their overlap; understanding them as addictive disorders and how they differ from SUD/MH; screening and referral techniques; and an overview of treatment, barriers, and future trends. Tana Russell, a Certified Gambling Counselor, and Kitty Martz, a Certified Gambling Recovery Mentor, are both advocates for integrating problem gambling and gaming services into MH/SUD programs. They'll provide a critical SWOT analysis of the strengths, weaknesses, opportunities, and threats to integrating this work for both treatment professionals and peers. Get ready to write and stretch because this session will be interactive, engaging, and possibly challenging.

1 – 5 p.m.

Concurrent Workshops

***LGBTQ+ & Gambling Disorder: A Cultural Competency Primer***

**Timberline**

Presented by: Michelle Malkin, PhD

It is generally known that the LGBTQ+ community face addiction at higher rates than the general population. This presentation will provide participants with a richer understanding of LGBTQ+ individuals (including basic knowledge of identities and terms), empirical research to understand the prevalence of LGBTQ+ gambling and risk toward disordered gambling, and how to use LGBTQ+ cultural competency tools to best work with LGBTQ clients and their families around these issues.



**OREGON  
LOTTERY™**

Together, we do good things.

**UPPER SKAGIT INDIAN TRIBE**





**FOUNDATIONS IN GAMING DISORDER**

# CORE TRAINING

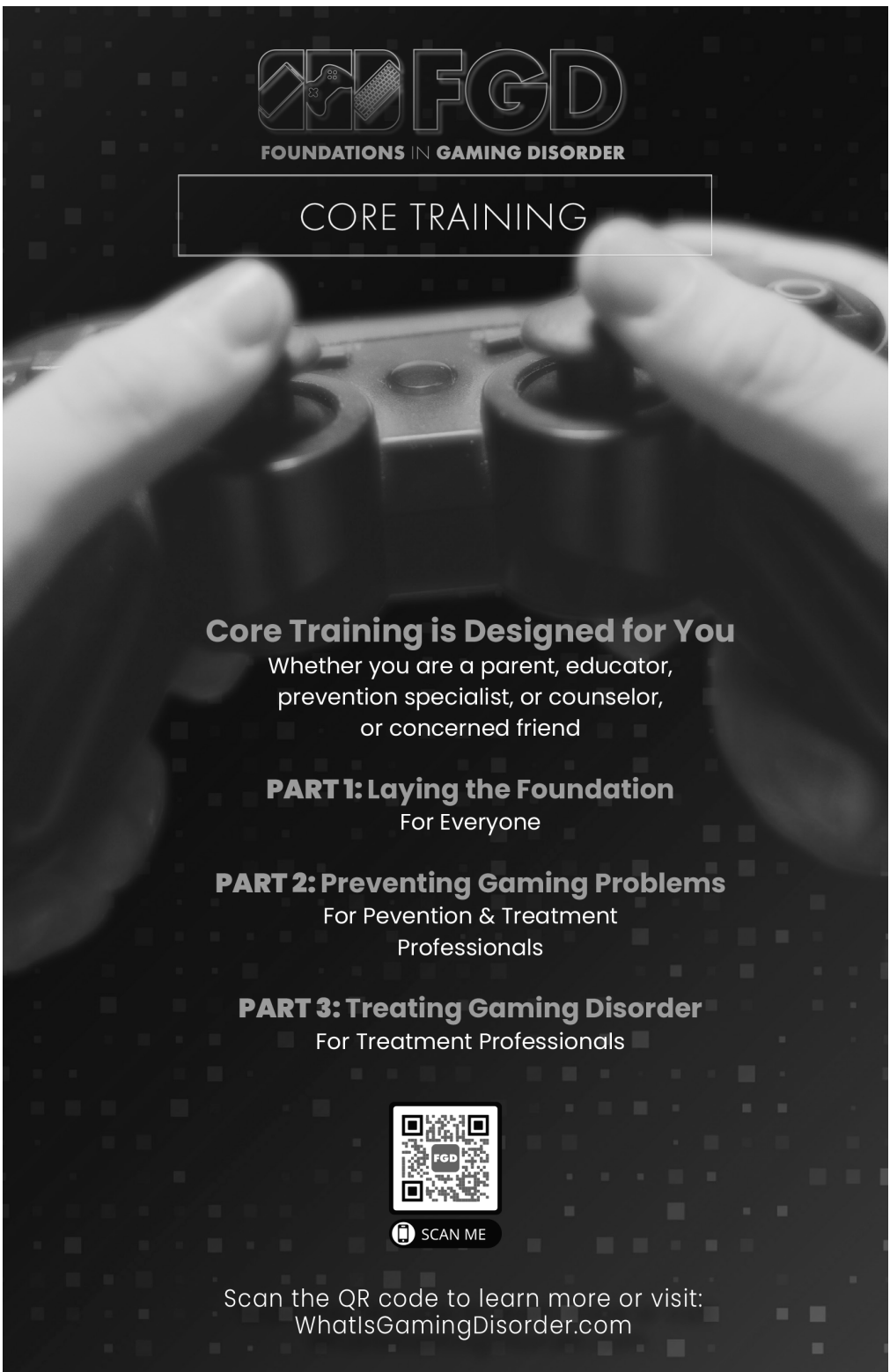

## **Core Training is Designed for You**

Whether you are a parent, educator,  
prevention specialist, or counselor,  
or concerned friend

**PART 1: Laying the Foundation**  
For Everyone

**PART 2: Preventing Gaming Problems**  
For Prevention & Treatment  
Professionals

**PART 3: Treating Gaming Disorder**  
For Treatment Professionals



SCAN ME

Scan the QR code to learn more or visit:  
[WhatIsGamingDisorder.com](http://WhatIsGamingDisorder.com)





## Foundations in Gaming Disorder Core Training

Whether you are a parent, educator, prevention specialist, or counselor, **Foundations in Gaming Disorder** – Core training is designed for you. The training will help dispel myths about gaming, provide practical skills and parenting techniques to help set limits, and identify support for spouses, partners, and other loved ones. Information is offered to help understand rating systems, the overlap of gambling elements and, ultimately, to have a healthier relationship with games.

Get Started Today! Register at [WhatsGamingDisorder.com](https://WhatsGamingDisorder.com)

It's a greatly underdiagnosed and undertreated condition.

It's important for behavioral health counselors to screen for it because it can cause other problems.

— Clifford Sussman, MD

**214.4M**

**Estimated US Gamers**

Entertainment Software Association  
(2020)

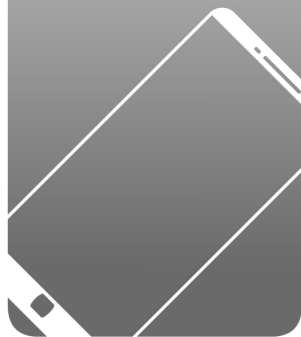

**3%–4%**

**Gamers Living with Gaming Disorder**

Stevens, Dorstyn, Dell'abbro, and King  
(2020)



**8.6M**

**Potential U.S. Gamers Living with Gaming Disorder**

Entertainment Software Association  
(2020)



[WhatsGamingDisorder.com](https://WhatsGamingDisorder.com)





1 – 5 p.m.

Concurrent Workshops

***Internet & Technology Addiction: Practical Application of Effective Strategies***

**Clackamas**

Presented by: Joshua Germain, MA, LMHC

The hope of this workshop session is to provide clinicians with the opportunity to practice effective therapeutic interventions that can be used when treating internet and technology addiction. Participants will first watch the presenter highlight helpful and unhelpful treatment strategies via role play. Audience members will collaboratively discuss and identify skills that were shown during the mock therapy session. The presenter will then use visual aids to highlight the reason and importance of each of the effective tools. In small groups, each participant will take their turn at practicing these newly learned strategies via role play exercises. Feedback from fellow group mates will be encouraged to further the understanding and implementation of the key concepts. Through group discussion, participants will have the space to ask questions, share their experience of using these skills (what felt difficult, what felt natural...etc.), and to reflect on how they might integrate what has been learned into their current work.

Tuesday, April 30

7 - 8 a.m.

Registration

Main Lobby

Breakfast

Clark

8 a.m. - Noon

Concurrent Workshops

***Use Inclusive Language to Build Trust (Part 1)***

**Multnomah**

Presented by: Suzanne Wertheim, Ph.D.

Every single thing you say and write affects your relationships with other people. When working with people struggling with problem gambling, trust is paramount - as is being able to anticipate other perspectives and pain points. Inclusive language helps people feel seen, heard, and valued. It deepens relationships and improves trust. In this workshop, we will show why the dictionary isn't the ultimate authority on whether or not a word is problematic. We will go over linguistic concepts that allow you to move beyond the dictionary. We will cover the six principles of inclusive language using relevant examples. And will do a deep dive into language challenges directly relevant to people providing support in the area of problem gambling, including variability in how to show respect.

8 a.m. - Noon

Concurrent Workshops

***Clinical Supervision (Part 1)***

**Clackamas**

Presented by: Wiley Harwell, D.Min, LPC, ICGC-II, BACC

An exploration of the dynamics of clinical supervision using the Integrative Development Model and a comparison of learning a mindfulness practice. This workshop will take the learner through a comprehensive model of two disciplines to illustrate how learning a new skill in one practice can be applied in principle to a multitude of skills. This presentation is a demonstration of the learning process for the young counselor and how to guide them to higher levels of competency.





Noon – 1 p.m. Lunch/Break Exhibits

Clark

1 – 5 p.m.

Concurrent Workshops

***Use Inclusive Language to Build Trust (Part 2)***

**Multnomah**

Presented by: Suzanne Wertheim, Ph.D.

Every single thing you say and write affects your relationships with other people. When working with people struggling with the problem gambling, trust is paramount - as is being able to anticipate other perspectives and pain points. Inclusive language helps people feel seen, heard, and valued. It deepens relationships and improves trust. In this workshop, we will show why the dictionary isn't the ultimate authority on whether or not a word is problematic. We will go over linguistic concepts that allow you to move beyond the dictionary. We will cover the six principles of inclusive language using relevant examples. And will do a deep dive into language challenges directly relevant to people providing support in the area of problem gambling, including variability in how to show respect.

1 – 3 p.m.

Concurrent Workshops

***Clinical Supervision (Part 2)***

**Clackamas**

Presented by: Wiley Harwell, D.Min, LPC, ICGC-II, BACC

An exploration of the dynamics of clinical supervision using the Integrative Development Model and a comparison of learning a mindfulness practice. This workshop will take the learner through a comprehensive model of two disciplines to illustrate how learning a new skill in one practice can be applied in principle to a multitude of skills. This presentation is a demonstration of the learning process for the young counselor and how to guide them to higher levels of competency.

3 – 5 p.m.

Concurrent Workshops

***The Final Best – Understanding How Risk Influences Suicidality in Gamblers***

**Clackamas**

Presented by: John Ackley, CADC II, CGAC II, QMHA II

Problem Gambling has the highest rate of suicidal ideation of all addictions, this we know. But the why and how of this catastrophic fact has never been answered, nor how the progression that leads to this should inform our interventions with our clients. Identifying the stages that lead up to suicidality, and separating out the evolution of the gambling progression is absolutely necessary for clinicians to be able to work in the different stages with their different motivations, different belief systems, and different risks involved as the gambler's behaviors progress in both urgency and consequences through the advancing stages of their addictive process.

**Don't Get Lost in the Crowd!**  
**FLASH YOUR BADGE!**

**If you're counting on Continuing Education Credits**  
Don't leave the room without getting  
your name badge scanned.





3 – 5 p.m.

Concurrent Workshops

### **Mastering the Game: Navigating Gaming Trends and Healthy Play**

**Timberline**



Presented by: Karen Hlady, MA, GIS, IGDC

- Context: Games & Gamers
- The Brain: Chemical Connection
- Gaming Disorder: Addiction & Mental Health
- Risk & Protective Factors
- Gaming World
- Strategies & Support

We're here to help.

# IF GAMBLING STOPS BEING FUN...

Take a Break, Take a Breath, and Reconnect.



**RECOVERY  
CAFÉ  
NETWORK**

Bring a Recovery Café  
to your community

[recoverycafenetwork.org](http://recoverycafenetwork.org)

The Puyallup Tribe



of Indians





# MAIN CONFERENCE SCHEDULE

## Wednesday, May 1

7 - 8:15 a.m.

Registration

Main Lobby

Breakfast (7:30-8:15 a.m.)

Salon East

8:30 – 10 a.m.

Welcome and Keynote

### ***Reviewing Emerging Treatments: TMS / Psilocybin / Ozempic / AI-based Therapies***

Salon East

Presented by: Timothy Fong, MD

As of 2024, there are no FDA-approved medications or medical devices for gambling disorder. This presentation will review the theory and practical applications of novel treatment approaches for gambling disorder, specifically, psychedelic compounds, transcranial magnetic stimulation and medications such as varenicline and cannabidiol (CBD). Understanding how and why these treatments may or may not apply to gambling disorder is critical to a deeper understanding of the biological underpinnings of gambling disorder. Practical strategies for educating and discussing the risk and possible benefits with individuals with gambling disorder and their family will be emphasized.

10 – 10:15 a.m. Break/Exhibits

Mt. St. Helens Ballroom Foyer

10:15 – 11:45 a.m.

Breakout Sessions

### ***The Healthy Use of Technology: Treatment in an Outpatient Setting***

Clackamas

Presented by: Edward Spector, Psy.D.

Technology can enhance our lives in many ways. It can make us more effective, productive and efficient. It also can entertain us and can help us connect with others. Unfortunately, when used to excess, technology can negatively impact our lives. Some individuals are unable to effectively limit their use of electronic media. The excessive use of electronic media can be an attempt to cope with significant psychological problems, such as depression, anxiety, ADHD, or social skills deficits. Dr. Spector will present on the healthy use of technology, including common forms of electronic games (computer, video, phone apps), the Internet (including the use of social networking sites and online communities), and the use of smart phones.



Get STARTed with Responsible Gaming

*Responsible Gaming Support, Training, And Resources*





10:15 – 11:45 a.m.

Breakout Sessions

***Technology-First Solutions to Help Mitigate Gambling Harms***

**Timberline**

Presented by: Sam DeMello & Jeffrey J Marotta, PhD, ICGC-II

Technological changes combined with liberalized gambling laws have been two major drivers behind the recent growth in gambling participation and revenues. This presentation will review several new technologies designed to reduce gambling harm, discuss their promises and limitations, and introduce a new comprehensive digital health platform that empowers users to create and maintain a healthy relationship with gambling, regardless of their goal: to quit, to control their spending and/or time gambling, or to maintain current levels of positive play. The new technology that will be introduced during the session is designed to appeal to the new generation of mobile and online gamblers by utilizing gamification features within an app, conversational language, community engagement, and multi-method teaching techniques and change strategies. The development approach and preliminary evaluation data for this new suite of technology driven solutions will be presented and discussed.

10:15 – 11:45 a.m.

Breakout Sessions

***Trauma and PTSD Among Individuals with Gambling Disorder***

**Multnomah**

Presented by: David Ledgerwood, PhD, LP

Co-occurring mental health disorders including PTSD/trauma are prevalent among those with gambling disorder. Yet few studies have explored the relationship between gambling and trauma or examined treatments that address both phenomena. Dr. Ledgerwood will discuss research on the link between gambling disorder and trauma/PTSD, provide case examples and discuss strategies for integrated treatment. He will present data from a newly completed clinical trial that compares an integrated treatment designed to address trauma and gambling concurrently (Seeking Safety) to one that addresses gambling disorder alone (CBT). He will also, more broadly discuss research on the treatment of co-occurring gambling disorder and mental health problems and provide recommendations for treating disorders concurrently

Noon – 12:30 p.m. Lunch/Announcements

Salon East

12:30 – 1:30 p.m.

Lunch Plenary

***Say It Loud, I'm Black and I'm Proud! Empowering Healing for People Who Gamble and Cultural Communities***

**Salon East**

Presented by: Deborah Haskins, PhD, LCPC, ACS, MAC, ICGC-II, CCGSO, BACC

Visible racial and ethnic persons and culturally diverse families and communities experience higher rates of health disparities and wellbeing impacts; often, these disparities are due to untreated childhood and community adversity, trauma, and experiences of marginalization and oppression (Ortiz et al., 2021) that are too frequently absent in research and disordered gambling and co-occurring substance use and mental health services (Haskins, In Press). Are we “doing a dance around” culture, equity and social justice too in our responsible gambling efforts? This proud African-descent scholar-practitioner, public health professional, and advocate will share lessons learned leading advocacy and healing by integrating cultural, equity, and social justice along with using “outside the box” strategies to expand healing for people who gamble and cultural communities.

1:30 – 1:45 p.m. Break/Exhibits

Mt. St. Helens Ballroom Foyer



# SCHEDULE-AT-A-GLANCE: PRE-CONFERENCE

Monday, April 29				
<b>7-8 a.m.</b>	Registration and Breakfast			Clark
<b>8-10 a.m.</b>	Pre-conference Workshops	Cris Rowan	Disrupting the Trajectory – Early Child Screen Management Initiatives Could Alter the Course of Youth Screen Addiction	Clackamas
<b>8 a.m. - Noon</b>		Kitty Martz, CGRM, CGAC-II and Tana Russell, SUDP, NCTTP, WSCGC-II, CGT	Analysis and Basics of Integrating Gambling & Gaming Recovery Skills into Practice (Part 1)	Multnomah
<b>10 a.m. - Noon</b>		Karen Hlady, MA, GIS, IGDC	Prevention Essentials: Prevention in Practice The SPF and more	Timberline
<b>Noon – 1 p.m.</b>	<b>Lunch Break/Exhibits</b>			Clark
<b>1-5 p.m.</b>	Pre-Conference Workshops	Kitty Martz, CGRM, CGAC-II and Tana Russell, SUDP, NCTTP, WSCGC-II, CGT	Analysis and Basics of Integrating Gambling & Gaming Recovery Skills into Practice (Part 2)	Multnomah
<b>1-5 p.m.</b>		Michelle Malkin, JD, PhD	LGBTQ+ & Gambling Disorder: A Cultural Competency Primer	Timberline
<b>1-5 p.m.</b>		Joshua Germain, MA, LMHC	Internet & Technology Addiction: Practical Application of Effective Strategies	Clackamas

Tuesday, April 30				
<b>7-8 a.m.</b>	Registration and Breakfast			Clark
<b>8 a.m. – Noon</b>	Pre-conference Workshops	Suzanne Wertheim, PhD	Using Inclusive Language to Build Trust (Part 1)	Multnomah
		Wiley Harwell, D.Min, LPC, ICGC-II	Clinical Supervision (Part 1)	Clackamas
<b>Noon – 1 p.m.</b>	<b>Lunch Break/Exhibits</b>			Clark
<b>1-5 p.m.</b>	Pre-Conference Workshops	Suzanne Wertheim, PhD	Using Inclusive Language to Build Trust (Part 2)	Multnomah
<b>1-3 p.m.</b>		Wiley Harwell, D.Min, LPC, ICGC-II	Clinical Supervision (Part 2)	Clackamas



<b>3-5 p.m.</b>		John Ackley CADC II, CGAC II, QMHA II	The Final Bet – Understanding How Risk Influences Suicidality in Gamblers	Clackamas
		Karen Hlady, MA, GIS, IGDC	Mastering the Game: Navigating Gaming Trends and Healthy Play	Timberline

## SCHEDULE-AT-A-GLANCE: MAIN CONFERENCE

<b>Wednesday, May 1</b>				
<b>7-8:15 a.m.</b>	Registration			Main Lobby
<b>7:30-8:15 a.m.</b>	Breakfast			Salon East
<b>8:30-10 a.m.</b>	Welcome and Keynote	Timothy Fong, MD	Reviewing Emerging Treatments: TMS / Psilocybin / Ozempic / AI-based Therapies	Salon East
<b>10-10:15 a.m.</b>	<b>Break / Exhibits</b>			Mt. St. Helens Foyer
<b>10:15 – 11:45 a.m.</b>	Breakout Sessions	Edward Spector, Psy.D.	The Healthy Use of Technology: Treatment in an Outpatient Setting	Clackamas
		Sam DeMello and Jefferey J Marotta, PhD	Technology – First Solution to Help Mitigate Gambling Harms	Timberline
		David Ledgerwood, PhD, LP	Trauma and PTSD among Individuals with Gambling Disorder	Multnomah
<b>Noon – 12:30 p.m.</b>	Lunch/Announcements			Salon East
<b>12:30 – 1:30 p.m.</b>	Lunch Plenary	Deborah Haskins, PhD, LCPC, ACS, MAC,ICGC- II, CCGSO, BACC	Say It Loud, I’m Black and I’m Proud!! Empowering Healing for People Who Gamble and Cultural Communities	Salon East
<b>1:30 – 1:45 p.m.</b>	<b>Break / Exhibits</b>			Mt. St. Helens Foyer
<b>1:45 – 2:45 p.m.</b>	Breakout Sessions	Frank Song and Joey Lambuth	Behavioral Health Correlates of Speculative Trading in Young Adults	Timberline
		Timothy Fong, MD	Increasing Treatment Demand: How to Get Clients to Make the First Call	Multnomah





<b>2:45-3 p.m.</b>	<b>Break / Exhibits</b>			Mt. St. Helens Foyer
<b>3-4 p.m.</b>	Breakout Sessions	Natalie Taylor and Ronda Hatefi	Starting Conversations: Building Take-A-Break Toolkits to Spread Gambling Safety Awareness	Multnomah
		Carmen Rosas	Securing a Financial Legacy: The Importance of Estate Planning for Gamblers	Timberline

<b>Thursday, May 2</b>				
<b>7:30-8:15 a.m.</b>	Registration and Breakfast	General Breakfast and WA Announcements with Roxane Waldron and Tana Russell		Salon East
<b>7:30-8:15 a.m.</b>	OHA Breakfast	OHA Breakfast for Oregon Providers		Clark-Washington
<b>8:30 – 10 a.m.</b>	Welcome and Keynote	Patrick Chester, Chaz Donati & Kitty Martz	Voices of Recovery	Salon East
<b>10-10:15 a.m.</b>	<b>Break / Exhibits</b>			Mt. St. Helens Foyer
<b>10:15 – 11:45 a.m.</b>	Breakout Sessions	David Ledgerwood, PhD, LP	Tailoring Gambling Treatments using the Pathways Model	Multnomah
		Paul R. Hales, J.D.	How To Comply with HIPAA Rules for Behavioral Health Providers	Timberline
		Jeremiah Weinstock, PhD	Motivational Interviewing Workshop: Refining Reflective Listening Skills	Clackamas
<b>Noon – 12:30 pm.</b>	<b>Lunch / Announcements</b>			Salon East
<b>12:30 – 1:45 p.m.</b>	Lunch Plenary	Keith Whyte	State of the Nation for Problem Gambling	Salon East
<b>1:45 – 2 p.m.</b>	Break / Exhibits			Mt. St. Helens Foyer
<b>2 – 3 p.m.</b>	Breakout Sessions	Jeremiah Weinstock, PhD	Guilt and Shame in the context of Gambling Disorder Treatment	Clackamas
		Scott Graupensperger, Joey Lambuth and Arvin Shaygan	Identifying health Correlates of Sports Betting in Young Adults	Multnomah
		Jerry Bauerkemper, BS, CCGC	Crime and Problem Gambling	Timberline





1:45 – 2:45 p.m.

Breakout Sessions

***Behavioral Health Correlates of Speculative Trading in Young Adults***

**Timberline**

Presented by: Joey Lambuth and Frank Song

Speculative trading is a popular activity among young adults with key similarities to gambling. This presentation Will explore the results of a longitudinal study on speculative trading activities and behavioral health indices (Including substance use behaviors) among young adults in Washington State.

1:45 – 2:45 p.m.

Breakout Sessions

***Increasing Treatment Demand: How to Get Clients to Make the First Call***

**Multnomah**

Presented by: Timothy Fong, MD

Many individuals with gambling disorder are not aware that they have a problem and do not seek treatment. Estimates place less than 10% of people with gambling disorder ever receive professional treatment. This presentation will review, discuss, and analyze innovative and fresh ideas and strategies to engage gambling disorder clients. Various strategies that have been tried (with varying degrees of success) from the California Gambling Education and Treatment System (Cal GETS) will be presented. Other strategies, borrowed from the addiction, mental health, and medical care systems for engaging difficult-to-reach populations will be reviewed, including using embedded screening tools, peer support, community outreach workers and targeted media campaigns. The result of this presentation will be to develop newer strategies to be considered for future implementation.

2:45 – 3 p.m. Break/Exhibits

Mt. St. Helens Ballroom Foyer

3 – 4 p.m.

Breakout sessions

***Starting Conversations: Building Take-A-Break Toolkits to Spread Gambling Safety Awareness***

**Multnomah**

Presented by: Ronda Hatefi and Natalie Taylor, MHA

This presentation will offer our bringing Take-A-Break mental wellness kits to community events as a case study. We plan to offer insights into coalition work, integrating gambling education into mental health initiatives, raising community readiness and interactive tabling as a means to start conversations about potential gambling harms. This session includes small group discussion on how to integrate these ideas into their work. This would offer connection with other participants and the chance to imagine what one-on-one conversations with community members could bring to their work. We are also excited to offer an interactive component where participants build their own Take-A-Break toolkits to bring home with them.





3 – 4 p.m.

Breakout Sessions

***Securing a Financial Legacy: The Importance of Estate Planning for Gamblers***

**Timberline**

Presented by: Carmen Rosas, JD/Esquire

This session aims to provide a comprehensive understanding of the intersection between estate planning and gambling addiction while offering actionable steps and collaborative solutions to support individuals in securing their financial future responsibly.

Thursday, May 2

7:30 - 8:15 a.m.

Registration

Main Lobby

OHA Breakfast for Oregon Providers  
(Breakfast starts at 7:45 a.m.)

Clark-Washington

General Breakfast and WA Announcements  
(Announcements start at 7:45 a.m. with Roxane Waldron and Tana Russell)

Salon East

8:30 – 10 a.m.

Welcome and Keynote

***Voices of Recovery***

**Salon east**

Presented by: Patrick Chester, Chaz Donati, and Kitty Martz, CGRM, CGAC-II, MBA

This presentation will be a panel discussion sharing inspirational stories of lived-experience and ongoing recovery from gambling. Panelists may share experiences of gambling at various ages and types of games, sports betting, impacts on personal and professional life, and the road of recovery through various pathways such as recovery community, peer support, and coaches. The panel will discuss how we, as a society, can bring awareness to this cause, and be the support and advocates for those who are going through similar concerns.

10 – 10:15 a.m. Break/Exhibits

Mt. St. Helens Ballroom Foyer

10:15 – 11:45 a.m.

Breakout Sessions

***Tailoring Gambling Treatments using the Pathways Model***

**Multnomah**

Presented by: David Ledgerwood, PhD, LP

Not all individuals with gambling disorder are the same for many reasons. Over the past two decades, it has become increasingly apparent that individuals develop gambling disorders for different reasons, and early research on treatments for gambling disorder have not explored tailoring of treatments based on these differing underlying etiological mechanisms. In this presentation, Dr. Ledgerwood discusses the importance of various subtyping models of gambling disorder, with an emphasis on the Pathways Model (developed by Blaszczynski and Nower, 2002), for understanding gambling disorder and informing its treatment. Dr. Ledgerwood will describe research on the Pathways model, with an emphasis on how this research may be useful for tailoring gambling disorder treatments.





10:15 – 11:45 a.m.

Breakout Sessions

***How To Comply with HIPAA Rules for Behavioral Health Providers***

**Timberline**

Presented by: Paul R Hales, J.D.

This session will explain the four HIPAA Rules (Privacy, Security, Breach Notification, and Enforcement) and basic HIPAA compliance for Behavioral Health Care Providers. The session will also address HIPAA coordination with the new (February 16, 2024) Part 2 Final Rule for SUD confidentiality.

10:15 – 11:45 a.m.

Breakout Sessions

***Motivational Interviewing Workshop: Refining Reflective Listening Skills***

**Clackamas**

Presented by: Jeremiah Weinstock, PhD

Motivational Interviewing (MI) is an evidence-based practice in the treatment of gambling disorders. This workshop will begin with a quick refresher on motivational interviewing and its evidence base in relation to gambling disorder. The main focus of the workshop is active learning activities that focus on therapist behaviors to resolve ambivalence and build intrinsic motivation to change. The hands-on workshop is intended for mental health providers who already have rudimentary knowledge of motivational.

Noon – 12:30 p.m. Lunch/Announcements

Clark-Washington

12:30 – 1:45 p.m.

Lunch Plenary

***State of the Nation for Problem Gambling***

**Clark-Washington**

Presented by: Keith Whyte

Keith Whyte, Executive Director of the National Council on Problem Gambling, will review the state of responsible gambling and gambling addiction in the United States and implications for stakeholders in the Pacific Northwest. He will discuss rising and shifting risk factors for gambling addiction especially among young, male online sports bettors. He will cover challenges and opportunities with advances in gambling technology and AI. He will describe national advocacy efforts including the GRIT Act and how stakeholders can participate and help advance well-being by minimizing harm from gambling problems.

1:45– 2 p.m. Break/Exhibits

Mt. St. Helens Ballroom Foyer

**It Takes a Community To Overcome Problem Gambling**

We're here to help those struggling with gambling problems, find help and community.

24/7 Confidential Helpline:



**CALL. TEXT. CHAT.**  
**1-800-547-6133**  
evergreencpg.org





2 – 3 p.m.

Breakout Sessions

### **Guilt and Shame in the Context of Gambling Disorder Treatment**

**Clackamas**

Presented by: Jeremiah Weinstock, PhD

Many individuals with gambling disorder (GD) experience feelings of guilt and shame. While these emotional experiences overlap, they are distinct and have different implications for GD treatment. Guilt refers to feeling responsible for a thought, act, or feeling in which the individual perceives wrong doing. Meanwhile, shame is characterized by critical self-evaluation regarding one’s thoughts, actions, and feelings that are likely to be judged harshly by others. This presentation will review guilt and shame in relation to GD, discuss how these emotional experiences facilitate and/or impede meaningful change, and how therapists can assess and address guilt and shame during GD treatment.

2 – 3 p.m.

Breakout Sessions

### **Identify Health Correlates of Sports Betting in Young Adults**

**Multnomah**

Presented by: Scott Graupensperger, Joey Lambuth and Arvin Shaygan

Identifying health risks/harms of sports betting, both short- and long-term, is needed to guide the timely development of prevention and intervention strategies for this rapidly growing addictive behavior. We provide an overview of research line, which is currently collecting longitudinal biweekly data (every other week for 1 year, with an additional distal follow-up survey) from emerging adults who report past-month sports betting (N=215) to gain a deeper understanding of the predictors, health correlates, and consequences of sports betting. The major themes for this presentation include a short overview of our findings related to psychosocial predictors of sports betting, how sports betting relates to mental health, and associations between problem sports betting and alcohol use. We will highlight key challenges the field is facing with regard to the sports betting landscape and its growing popularity, as well as challenges with studying and intervening on problem sports betting.

2 – 3 p.m.

Breakout Sessions

### **Crime and Problem Gambling**

**Timberline**

Presented by: Jerry Bauerkemper, BS, CCGC

This presentation will provide the participants with an understanding of the percentage of people impacted by Gambling Disorder who commit crimes, the general nature of those crimes and suggestions on how to provide positive outcomes for those who commit and are convicted of crimes. This workshop will address how to approach the court system with the recovery methods and processes involved in counseling people impacted by Gambling Disorder and their families.



## **Residential Treatment Services for Gambling Disorder** (for Washington State Residents)

To determine if your clients may be eligible for funding support for residential treatment contact the Evergreen Council on Problem Gambling: [info@evergreencpg.org](mailto:info@evergreencpg.org)





# Save-the-Date!

Cultural Awareness and Healing Support Conference

# FOUR DIRECTIONS



## September 16-19, 2024

Little Creek Casino Resort - Shelton, WA

*Four Directions* is Evergreen Council on Problem Gambling's annual fall conference. Many representatives of Tribal Nations in the Pacific Northwest have come together to plan this important conference, with the aim of *Honoring the Past and Protecting the Future* through holistic health, wellness, and recovery support.



EVERGREEN  
council on problem gambling

[evergreencpg.org](http://evergreencpg.org)



SCAN ME





# PRESENTERS



**John Ackley CADC II, CGAC II, QMHA II**, has been a Gambling Counselor for 10 years. He was a lead Gambling Counselor at Bridgeway Recovery services from 2020-2023, and also been a lead residential counselor at Santiam House, Oregon's dedicated residential gambling facility. John has presented on concepts underlying the addictive gambling process, specifically the differences that make Gambling Disorder its own unique challenge for both gamblers and clinicians alike.



**Jerry Bauerkemper, BS** was the first director of problem gambling (1992-1996) for the state of Nebraska, where he created the Gamblers Assistance program. He was appointed and served on Nebraska's Commission on Problem Gambling. He served on the Board of Directors for the National Council on Problem Gambling from 2001-2008 and from 2012-2016, and on the National Councils' Legislative committee. He has published research on the prevalence of problem gambling in the Nebraska Probation Department.



**Patrick Chester** is a former college baseball player, TEDx speaker, and graduate of The University of Washington. He now fills the role of Program Facilitator for Epic Global Solutions. Patrick is based in Seattle and spent 15 years living in the darkness of gambling addiction. His final bet was February 1st, 2015.



**Sam DeMello**, spent the last 12 years scaling early-stage technology companies in the Bay Area and Boston. He led Talent Acquisition for Akili Interactive, pioneers in the field of Digital Therapeutics, who developed the first FDA-approved videogame to treat ADHD. Sam has struggled with a gambling addiction since his early teens. At Evive, he brings together his lived experience with gambling addiction and his professional expertise in software development to create technology-first tools to help prevent and reduce gambling harm.



**Chaz Donati** is a 33-year-old member of the gambling recovery community who has transformed his life and now dedicates his energy to helping others through his mental health concept, "Find Your MORE." His journey from living what most would consider a 'normal' life, to battling addiction, depression, and suicidal thoughts, exemplifies resilience, recovery, and self-discovery.



**Timothy Fong, MD**, Professor of Psychiatry at the Jane and Terry Semel Institute for Neuroscience and Human Behavior at UCLA, is board certified in adult and addiction psychiatry. He is the co-director of the UCLA Gambling Studies Program, and is also a member of the Steering Committee of the UCLA Center for Cannabis and Cannabinoids. He is a member of the UCLA Sports Psychiatry Service and is part of the UCLA Sports Medicine Mental Health Team. He is President-Elect of the American Academy of Addiction Psychiatry.



# PRESENTERS



**Joshua Germain MA, LMHC**, has become recognized for his work with adolescents and young adults struggling with internet and technology addiction. Josh was one of the primary therapists at the nation's first and foremost internet and technology treatment centers, reSTART Life, which addresses the use of video games, social media, pornography, online gambling, television use, and a wide range of potential cross-addictions. In 2023, Josh opened his own private practice treating internet and technology addiction.



**Scott Graupensperger, PhD**, is an Assistant Professor of Psychiatry and Behavioral Sciences at the University of Washington. He leads an active and productive lab focused on prevention of risk behaviors among young adults, including gambling, substance use, and mental health (and the intersection of all three domains). Dr. Graupensperger has 64 peer-reviewed publications and has brought in more than 3 million dollars in research funding.



**Paul R Hales, J.D** manages an international HIPAA privacy and security practice based in St. Louis. He is an attorney licensed to practice before the U.S. Supreme Court, a graduate of Columbia University Law School, and a Senior Counselor of the Missouri Bar. Paul began his legal career as an appellate lawyer in the office of the noted civil rights attorney Louis Gilden. He went on to litigate complex civil cases in federal and state courts. He wrote The HIPAA E-Tool®, an Internet-based Software as a Service product for health information privacy education and compliance.



**Wiley Harwell LPC, ICGC-II, BACC**, is the Ex. Dir. of Oklahoma Association on Problem Gambling and Gaming, the state affiliate for the National Council on Problem Gambling of which Wiley served on the board for six years, including two as president. Wiley has taught problem gambling, mindfulness, and Basic Gambling Counselor Training classes across the country. In the past Wiley was the director of an employee assistance program, has been an associate professor in professional counseling at OU, and has taught all the required courses for LADC licensure.



**Deborah Haskins, PhD, ICGC-II, BACC, LCPC**, a retired Counselor Educator (25 years), received her Ph.D. in Pastoral Counseling (Loyola College, Maryland now Loyola University). Dr. Haskins is an International Clergy Lay Problem Gambling and Spiritual Outreach, Master Addictions Counselor. Dr. Haskins has trained mental health professionals to understand disordered gambling and provide culturally relevant services. She assists practitioners and faith and spiritual communities with incorporating "mental health delivery beyond traditional formats."



**Ronda Hatefi** founded Oregonians for Gambling Awareness Organization after the loss of her brother to a gambling addiction. She has run her non-profit to bring hope, help, and awareness for more than 28 years. Her passion is in helping those who struggle as well as their family members by being out in the community every chance she gets. She loves her job as preschool teacher and spending time with her family, especially her four grandchildren.



# CONNECT WITH US!



## READ, WATCH, LISTEN, AND ATTEND.

### **ECPG LIVE!**

LIVE VIDEO DISCUSSIONS ON HOT TOPICS WITH INDUSTRY LEADERS

### **KALEIDOSCOPE**

REFLECTIONS OF DIVERSE VIEWS ON MENTAL HEALTH EQUITY

### **CONNECTIONS**

A HEALTHY GAMBLING AND GAMING PODCAST

## **SOCIAL MEDIA, BLOG, AND EVENTS**

[evergreencpg.org/connect](https://evergreencpg.org/connect)



# PRESENTERS



**Karen Hlady, MA GIS, IGDC** has been contracting with Gambling Support BD (GSBC) on behalf of Vancouver Island Gaming Support (VIGS), offering an array of gaming and gambling education workshops. With more than 25 years of experience in the community education, health, and social services field, she has provided culturally responsive support services to vulnerable youth and families negatively impacted by a variety of mental health issues and addictions. Karen currently serves on the Canadian Problem Gambling Certification Board.

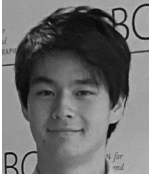

**Joey Lambuth** is a current undergraduate psychology student at the University of Washington. His research is on understanding the health correlates of addictive behaviors, primarily gambling, among the young adult population.



**David Ledgerwood, PhD**, is a clinical psychologist, Professor, and Director of the Nicotine and Tobacco Research Division in the Department of Psychiatry and Behavioral Neurosciences at Wayne State University School of Medicine. He has published research articles on problem gambling focusing on co-occurring psychopathology, impulse control, treatment outreach and effectiveness. Dr. Ledgerwood has been Associate Editor for *Psychology of Addictive Behaviors* and is a Regional Assistant Editor for *International Gambling Studies*.



**Michelle Malkin, JD, PhD**, is an Assistant Professor of Criminal Justice and the Director of the Gambling Research & Policy Initiative at East Carolina University. Dr. Malkin's research interests include a focus on gambling disorder, gambling motivated crime, and gambling prevalence and risk among under-researched identities, including women, LGBTQ+ individuals, and emerging adults.



**Jefferey Marotta PhD, ICGC-II** has specialized in the field of problem gambling for 27 years with more than 200 publications and national presentations. Jeff has a doctorate in Clinical Psychology from the University of Nevada, Reno. Utilizing his background in research and evaluation, clinical practice, service administration, and program and policy development, he now services as President and Senior Consultant with Problem Gambling Solutions, Inc.



**Kitty Martz, CGRM, CGAC-II, MBA** is an advocate, educator, mentor, and counselor. She is the Executive Director of Voices of Problem Gambling Recovery in Portland, and president of the Oregon Council on Problem Gambling. As a person with lived experience in gambling harm, Kitty works directly with peers to support their gambling recovery, develops curriculums, establishes procedural frameworks, and delivers engaging training seminars on a local and national level. She can be reached at [www.yggr.net](http://www.yggr.net)



**Carmen Rosas JD/Esquire** as the founder of Carmen Rosas Law, APC, and CEO of EmpowHER Yourself, LLC, Carmen has more than 11 years of working with families and business owners who want to ensure their wealth can transfer to the next generation. She discusses topics including money mindset, legacy planning, financial empowerment, and business continuity. She has been featured In *Forbes*, *Huff Post*, *Create & Cultivate*, *Belatina*, the *Super Mamas* podcast, and more.

# PRESENTERS



**Cris Rowan** is a biologist, occupational therapist, international speaker, and author of *Virtual Child* who is passionate about creating sustainable futures for children and their families. Cris has offered more than 400 workshops/webinars and is presently completing a certification training program in Balanced Technology Management for parents, health, and education professionals.

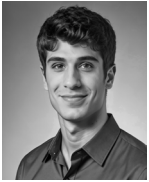

**Arvin Shaygan**, is a Senior Psychology student at the University of Washington, who has worked with Dr. Graupensperger on gambling and other addictions research. He is a recipient of the Evergreen Council's Advanced Undergraduate Academic Scholarship. Mr. Shaygan will be pursuing medical school and intends to focus on Psychiatry, where his interests are in treating addiction-based psychopathology.



**Frank Song** is a PhD Candidate in Clinical Psychology at the University of Washington. His primary research is focused on understanding risk and protective factors of problem gambling and speculative trading behaviors in young adults. He has presented his research on problem gambling at organizations including the Puget Sound VA, SAMHSA Northwest Addiction Technology Transfer Center, and International Center for Responsible Gambling.



**Edward Spector, Psy.D.** is a nationally recognized expert in digital addiction. Since 2009, Dr. Spector has specialized in the treatment of compulsive tech use in his Maryland-based private practice. His work has been recognized via media appearances on Good Morning America, Matter of Fact with Soledad O'Brien, NPR's the Diane Rehm show, as well as ABC and NBC News. He is a sought-after speaker and presenter on innovative and groundbreaking treatments for addiction and mental health as it relates to digital media.



**Natalie Taylor, MHA**, a Community Health Analyst working for Lane County Public Health in Oregon is passionate about her work in public health prevention, raising community awareness about the potential harms of gambling. She has a master's degree in health advocacy from Sarah Lawrence College and fights to bring an equity lens to all her projects. When not at work she can be found cooking, reading, and snuggling with her baby daughter.



**Jeremiah Weinstock, PhD**, is a Professor of Psychology at Saint Louis University. His clinical and research efforts center on addressing the difficulties in helping individuals with addictions make lasting and meaningful changes in their lives. He focuses on the characterization, assessment, and treatment of gambling disorder. Much of this research is transitional, such as measures to assess gambling disorder and randomized clinical trials examining the efficacy of psychosocial interventions, such as motivational interviewing, cognitive behavioral therapy, and contingency management.



**EVERGREEN**  
council on problem gambling

# KEEP IT FUN, WASHINGTON!

*Sports Betting Can Stretch the Fun to its Limits.  
If Things Feel Out of Hand, We're Here to Help*

**RESPONSIBLY**



SCAN ME





# PRESENTERS



**Suzanne Wertheim, PhD**, is a national expert on language and bias. After getting her Ph.D. in Linguistics from Berkeley, she held faculty positions at Northwestern, University of Maryland, and UCLA. Today, as head of Worthwhile Research & Consulting, Dr. Wertheim analyzes and addresses bias at work. Using the tools of linguistic anthropology, she guides clients to more inclusive language, content, and workplaces. Her book, *The Inclusive Language Field Guide*, was published in 2023.



**Keith Whyte**. Since October 1998, Keith has been Executive Director of the National Council on Problem Gambling (NCPG). Whyte has presented gambling issues in more than 40 US states and internationally in more than a dozen countries. He has testified at the request of the United States Congress on gambling-related Federal legislation and has appeared before numerous state legislative and regulatory bodies. He regularly discusses problem gambling issues in national and international print, radio, and broadcast media.

Best Practices and Broad Perspectives for  
**Voluntary Self Exclusion  
Program Development**



Also Available  
in eBook



# PROBLEM GAMBLING HELP AND SUPPORT FOR SERVICE MEMBERS AND THEIR LOVED ONES,

**ARE YOU CONCERNED ABOUT GAMBLING?  
TAKE A CONFIDENTIAL SELF-SCREEN:**

[evergreencpg.org/military-screen](http://evergreencpg.org/military-screen)

Find more help and resources at: [militarygamblingsupport.org](http://militarygamblingsupport.org)





TRAINING // COUNSELOR CERTIFICATION

# Washington State Gambling Counselor Certification

Learn More by scanning the QR Code or visiting:  
[evergreencpg.org/training/counselor-certification](http://evergreencpg.org/training/counselor-certification)



# SAVE-THE-DATE!

## Evergreen Council on Problem Gambling July Quarterly Training

Richland, WA – July 10-12, 2024

Two training options available:

- **Gambling Counselor Core Training**
- **Advanced Gambling Counselor Skill-Development Workshop Retreat**



# Cultural Awareness and Healing Support Conference FOUR DIRECTIONS

Save-the-Date!  
 September 16-19, 2024  
 Little Creek Casino - Shelton, WA

Scan the QR code or visit  
[evergreencpg.org/training](http://evergreencpg.org/training)

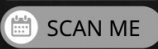

## IGCCB Exam Prep eCourse

With so many motivated counselors across the nation preparing each year to take the International Gambling Counselor Certification Board (IGCCB) Gambling Counselor exam, the Evergreen Council on Problem Gambling (ECPG) and our partners wanted to do more to help counselors feel prepared and confident when actually taking the exam. Certification is a challenging and worthwhile achievement. This course is designed to supplement your study and core trainings with practice exam questions, listings of study resource materials, and test-taking tips. The self-paced program allows you to study on your own schedule – from your PC, phone, or tablet. Once you are registered, you can return to the eCourse as often as you'd like for as long as 120 days.

### Program Goals:

- To provide an overview of what counselors can expect from the certification and examination process.
- To provide at least 100 practice questions that model the style, topics, and types of questions that will appear on the exam.
- To provide study resources and sources of reliable information and best practices on the treatment of Problem Gambling and Gambling Disorder.
- To help clinicians develop their knowledge and skills while preparing to take the exam.

## PROGRAM DETAILS

**ESTIMATED TIME TO COMPLETE:** 2 hours

**FORMAT:** Online Self-Paced Study

**PRICE:** \$22 (ECPG Member)/ \$25 (Non-member)

**CE CREDITS:** 2

**Approved for CE hours by:** NAADAC, NCPG, AAHCPAD, and MHACBO

### Register Today!

Scan the Code or Visit: [evergreencpg.org](http://evergreencpg.org)



**SCAN TO REGISTER**

## COMMUNITY ADVISORY COMMITTEES

Social justice is a Public Health issue that compels us to eliminate inequities based on race, gender, religion, ethnicity, sexual orientation, age, or disability. Our field is familiar with the inequities and barriers built by stigma and fear. Public health requires the ability to provide even the most basic of services without stigma; without discrimination; without humiliation; without marginalization; without racism.

The experience, insights, and knowledge shared by Community Advisory Committees are vital to helping ECPG offer and enhance programs that meet the needs of diverse communities we serve throughout Washington State.

### JOIN A COMMITTEE

Applications are accepted at any time whether or not there are current openings on any committees. Your application will be kept on file for a minimum of one year for consideration.

- Asian/Pacific Islander
- Black
- Faith-Based
- Healthcare
- Latinx
- LGBTQIA+
- Military/Veterans
- Native American
- Recovery Community
- Senior (60+)
- Young Adult (18-21)

Learn more about ECPG's commitment to community:  
[evergreencpg.org/awareness/culture-and-community/](https://evergreencpg.org/awareness/culture-and-community/)



**COMMUNITY ADVISORY COMMITTEES**  
APPLICATION PDF





**HOLIDAY INN PORTLAND | COLUMBIA RIVERFRONT**

**LOBBY LEVEL—2ND FLOOR**

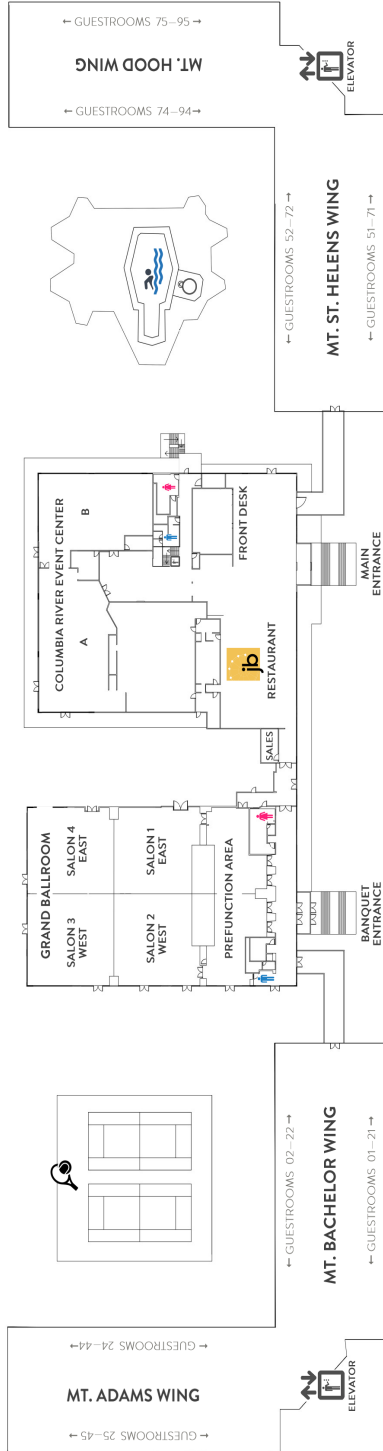

**Zen Room**

**LOWER LEVEL—1ST FLOOR**

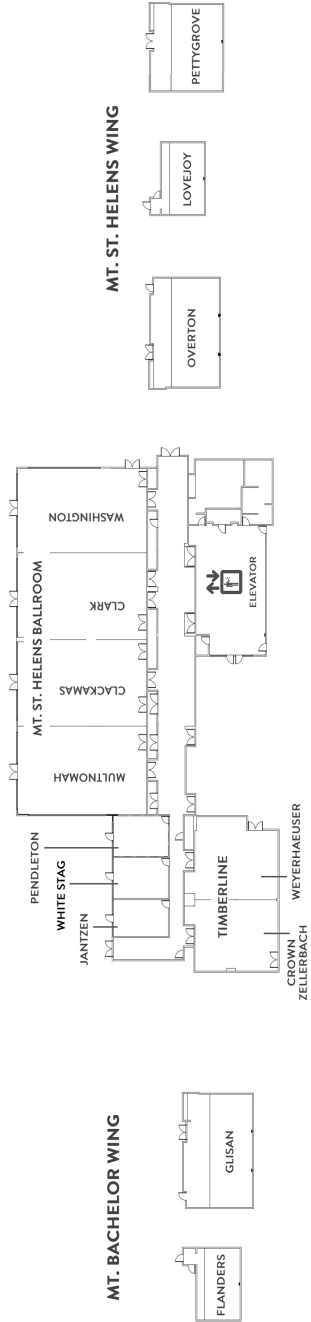



WESTERN REGIONAL CONFERENCE ON GAMBLING AND GAMING HEALTH AWARENESS

# FOCUS ON THE FUTURE

## MAIN CONFERENCE SCHEDULE AT-A-GLANCE

### Wednesday, May 1

7 - 8:15 am	Registration and Breakfast
8:30 - 10 am	Welcome & Keynote
10 - 10:15 am	Break / Exhibits
10:15 - 11:45 am	Morning Breakout Sessions
Noon- 12:30 pm	Lunch / Announcements
12:30 - 1:30 pm	Lunch Plenary
1:30 - 1:45 pm	Break / Exhibits
1:45 - 2:45 pm	Afternoon Breakout Sessions
2:45 - 3 pm	Break / Exhibits
3 - 4 pm	Afternoon Breakout Sessions

### Thursday, May 2

7:30 - 8:15 am	Registration and Breakfast
8:30 - 10 am	Welcome & Keynote
10 - 10:15 am	Break / Exhibits / Hotel Checkout
10:15 - 11:45 am	Morning Breakout Sessions
Noon - 12:30 pm	Lunch / Announcements
12:30 - 1:45 pm	Lunch Plenary
1:45 - 2 pm	Break / Exhibits
2-3 pm	Afternoon Breakout Sessions

